

# TrustKeeper® PCI Manager

**For small businesses that are managing data security for the handling of credit card data, and must validate PCI compliance for their acquiring bank or processor.**

## About Trustwave®

Trustwave is the leading provider of PCI DSS compliance validation and data security solutions to small merchants. Trustwave provides a unique approach with comprehensive solutions that include its flagship TrustKeeper® compliance management software and other proprietary security solutions. Trustwave has helped thousands of small merchant organizations manage compliance and secure their network infrastructure, data communications and critical information assets.

*Manage your PCI compliance and data security task list with TrustKeeper's PCI Manager. With the industry's only To Do List On-demand, Web-based PCI and security tool, that simplifies the complexity of PCI and shortens your time to achieve compliance validation.*

## TrustKeeper PCI Manager: PCI Made Easy

Trustwave's TrustKeeper PCI Manager provides PCI compliance validation services for merchants of all sizes, helping even the smallest merchants achieve and maintain compliance. TrustKeeper PCI Manager features the industry's first To Do List, to help you accelerate and track their security efforts. The experience using TrustKeeper PCI Manager experience is simple and efficient, designed for merchants with varying levels of IT experience.

**"TrustKeeper simplified the process so I could protect my business and comply with PCI DSS."**

*- Restaurant Owner*

## The Small Merchant Challenge

Small merchants are focused on running their businesses: customer service, product delivery and day-to-day operations. Often, these small businesses have few if any IT resources, and as business owners, are not solely focused on data security or IT needs. There is also often a lack of awareness of data breach threats – what they are and how they occur. At the same time, statistics show small businesses are at the greatest risk of payment card compromise.

Trustwave's own forensics reports show that small retailers, brick and mortar retailers and specific POS systems designed for small business are the most often breached. The risk of the small merchant is real. Data security and compliance are the best way to combat this threat – but the process is often complex and technical.

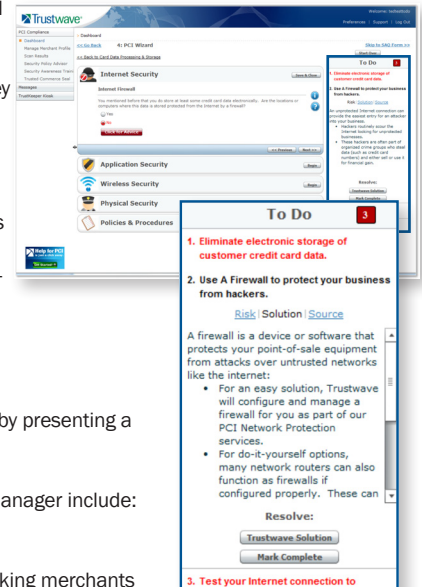

## Facilitate compliance with TrustKeeper PCI Manager

TrustKeeper PCI Manager simplifies the process for small merchants, by presenting a pathway that's customized to each merchant's unique business.

The features of this new and easy-to-use version of TrustKeeper PCI Manager include:

### PCI Wizard and To Do List

Trustwave's intelligent PCI Wizard helps simplify the process, walking merchants step-by-step through the process for certifying PCI DSS compliance. The To Do List, the first of its kind in the industry, clearly and simply tracks the areas that need action by the merchant as they complete each area of self-assessment. This process makes it easy for merchants to both understand what needs to be addressed, how they can find the solution, and an easy check-off process once the task is complete.

### Get to Green

Take advantage of our new To Do List feature. When you choose the PCI Wizard, you'll see the new To Do List on the right hand side of the screen, to help track your open compliance tasks and achieve PCI certification.



## Security within TrustKeeper

**Communication:** All sensitive data transferred between TrustKeeper and a merchant or partner is encrypted in transit.

**Data Storage:** The TrustKeeper portal uses a secure multi-tiered architecture to ensure all client data is removed from any Internet-facing systems. Trustwave's secure data centers utilize multiple protection layers and devices (such as firewalls and intrusion prevention systems) to segment these layers. TrustKeeper is routinely scanned for vulnerabilities and tested by Trustwave's own expert application security and penetration test teams.

**Access Controls:** Access to data is tightly controlled. Merchants can only access their own data, and partners can only access data relevant to their merchants. All user access requires (at least) passwords with strong password policy enforcement (minimum length, prohibitions on password re-use, session timeouts, etc.).

**Availability:** Trustwave utilizes distributed systems in multiple data centers, along with network load balancers, to ensure high availability of the system and vulnerability scanning components.

## Compliance Jumpstart and Ongoing Monitoring with TrustKeeper Agent

Included with TrustKeeper PCI Manager is access to the TrustKeeper Agent, Trustwave's powerful compliance monitoring and data discovery tool. With an easy two-minute download, TrustKeeper Agent jumpstarts a merchant's compliance efforts, and monitors compliance over time. Once installed, the Agent acts as a "beaconing" device—sending back information on the system on which it is installed.

"I've tried to become compliant before. This time, TrustKeeper made all the difference."

- e-commerce retailer

The Agent provides several benefits once installed, such as effortless scanning of remote locations that use dynamic IP addresses. The Agent can help detect the storage of prohibited data, such as payment card track or PAN data, on any machine on which the Agent is installed. The Agent provides ongoing compliance monitoring by continually analyzing the security configurations of those machines, ensuring the machines are in accordance with compliance requirements.

### Online Education

Throughout the boarding process, merchants are provided with access to on-demand help text and tutorials. These self-guided, easy-to-understand tools break down each step toward achieving compliance with TrustKeeper. Some of the tools available include:

- Security Awareness Training – Online Modules available for a variety of businesses and employee roles
- PCI Assistant – Online guided tutorial, self-directed according to which modules are most important to you
- Online FAQ – Offers the answers to common questions and concerns

### Security Policy Advisor

All users have access to Trustwave's Security Policy Advisor, a set of templates and guides to help merchants develop their own set of documented data security policies and procedures. Merchants need to have and implement processes and documentation, and the Security Policy Advisor helps merchants certify with specific PCI requirements.

### Vulnerability Scan Management

For merchants required to perform scanning of their card-processing environment, TrustKeeper's proprietary scanning engine becomes an integral component of the compliance process. This scanning engine tests for more than 6,000 network operating system and application vulnerabilities, (including enhanced checks for SQL injection and cross-site scripting vulnerabilities), and supports both internal and external vulnerability scanning. Merchants can use TrustKeeper Agent to jump start this process.

### Trusted Commerce and Certification

Once certified in TrustKeeper, merchants can display the Trusted Commerce site seal on their e-commerce or marketing Web site to assure their customers of the security of their operations. A printable PDF Certificate of Compliance is also available within TrustKeeper for merchants to print and display, or share with their sponsor bank.

### Security Solutions

Step up to security, with the TrustKeeper Kiosk – this unique feature of TrustKeeper provides merchants access to the solutions they need when they are addressing specific compliance needs within PCI Manager.

The screenshot displays the TrustKeeper PCI Manager interface. At the top, it says "Welcome: tedtestudo2" and includes links for "Preferences", "Support", and "Log Out". The main content area shows a "4: PCI Wizard" section with a green checkmark icon and the message "Congratulations! PCI Wizard successfully completed." Below this, there are several security categories, each with a green checkmark icon and a "Review Q & A" button:

- Internet Security
- Secure Communications
- Wireless Security
- Device & Computer Security
- Remote Access & Management
- Physical Security
- Policies & Procedures

On the right side, there is a "To Do List" section with a red notification icon and the text "No open To Do tasks". A "Start Over" button is also visible. The left sidebar contains navigation options: "Dashboard", "Manage Merchant Profile", "Scan Results", "Security Policy Advisor", "Security Awareness Training", "Trusted Commerce Seal", "My Agents", "Messages", and "TrustKeeper Kiosk". A "Help for PCI" button is located at the bottom left.